

CAPT-LOCKS

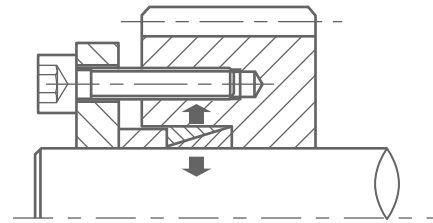

suit for shaft f10~f150 (mm)

E CAPT-LOCKS include two inner and outer taper rings, the structure is both simple and compact. It needn't big installation space, completely circular without split and with good dynamic balance property.

E CAPT-LOCKS bring the high surface pressures on shaft by the pressing flange, compress the shaft and the hub hole tightly to achieve the connection of them. It can seal the shaft surface and inner hole and obtain good results. It is applicable to the light load, small space installation occasion.

According to the different shaft diameter and structure, there are F type pressing flange and H type pressing flange for your choosing.



Nomenclature for CAPT-LOCK type E

CL 36 X 42 E

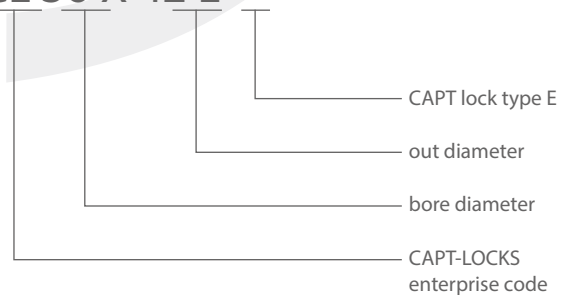

E CAPT-LOCKS

CAPT-LOCKS

E

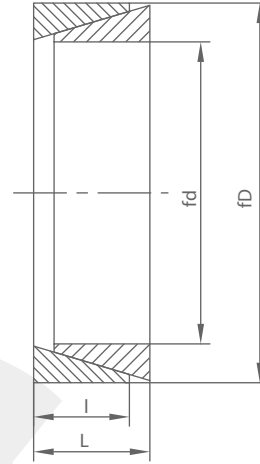

E CAPT-LOCKS[®]

Catalog	Fundamental dimensions		Rated load				Ps	Ph	G	kg
	dxD	L	l	Fo(Kn)	Fe(Kn)	Mt(Kn.m)	Ft(Kn)	Mpa	Mpa	
CL10x13E	4.5	3.7	5.9	6.2	0.007	1.4	98	75	0.002	
CL12x15E	4.5	3.7	5.0	7.4	0.010	1.67	98	78	0.002	
CL13x16E	4.5	3.7	4.7	8.0	0.012	1.8	98	79	0.002	
CL14x18E	6.3	5.3	8.1	12.3	0.020	2.8	98	76	0.005	
CL15x19E	6.3	5.3	10.3	13.2	0.023	3.0	98	77	0.005	
CL16x20E	6.3	5.3	9.8	14.1	0.025	3.2	98	78	0.006	
CL17x21E	6.3	5.3	9.2	15.0	0.028	3.4	98	79	0.006	
CL18x22E	6.3	5.3	8.9	15.9	0.032	3.6	98	80	0.008	
CL19x24E	6.3	5.3	12.3	16.8	0.036	3.8	98	77	0.008	
CL20x25E	6.3	5.3	11.9	17.6	0.039	4.0	98	78	0.01	
CL22x26E	6.3	5.3	8.9	19.4	0.047	4.4	98	83	0.01	
CL24x28E	6.3	5.3	8.2	21.2	0.057	4.8	98	84	0.01	
CL25x30E	6.3	5.3	9.7	22.1	0.061	5.0	98	81	0.01	
CL28x32E	6.3	5.3	7.2	24.7	0.076	5.6	98	86	0.01	
CL30x35E	6.3	5.3	8.3	26.5	0.088	6.0	98	84	0.01	
CL32x36E	6.3	5.3	7.7	28.2	0.102	6.3	98	87	0.015	
CL35x40E	7	6	9.9	34.9	0.137	7.9	98	86	0.02	
CL36x42E	7	6	11.4	35.9	0.145	8.1	98	84	0.02	
CL38x44E	7	6	10.9	37.9	0.163	8.6	98	84	0.02	
CL40x45E	8	6.6	13.5	44.1	0.201	9.9	98	87	0.025	
CL42x48E	8	6.6	15.3	46.1	0.220	10.5	98	86	0.04	
CL45x52E	10	8.6	25.6	64.7	0.321	14.6	98	85	0.043	
CL48x55E	10	8.6	24.1	68.6	0.378	15.6	98	85	0.045	
CL50x57E	10	8.6	23.2	71.5	0.401	16.2	98	86	0.05	
CL55x62E	10	8.6	21.3	78.4	0.481	17.8	98	87	0.06	
CL56x64E	12	10.4	28.6	97.0	0.620	21.7	98	86	0.074	
CL60x68E	12	10.4	26.9	104	0.701	23.5	98	87	0.074	
CL63x71E	12	10.4	25.6	109	0.780	24.5	98	87	0.08	
CL65x73E	12	10.4	24.9	113	0.813	25.3	98	87	0.08	
CL70x79E	14	12.2	30.4	142	1.121	32.0	98	87	0.11	
CL71x80E	14	12.2	30.0	144	1.151	32.3	98	87	0.12	
CL75x84E	14	12.2	33.7	152	1.268	34.2	98	86	0.12	
CL80x91E	17	15	47.1	200	1.772	45	98	86	0.19	
CL85x96E	17	15	44.6	212	2.021	48	98	87	0.20	
CL90x101E	17	15	42.2	224	2.252	51	98	88	0.22	
CL95x106E	17	15	40.1	237	2.530	53	98	86	0.23	
CL100x114E	21	18.7	59.8	311	3.453	70	98	87	0.38	

CAPT-LOCKS

E

E CAPT-LOCKS®

Catalog	Fundamental dimensions		Rated load			Ps	Ph	G	kg
	dxD	L	I	Fo(Kn)	Fe(Kn)	Mt(Kn.m)	Ft(Kn)	Mpa	
CL105x119E	21	18.7	57.6	323	3.82	73.2	98	87	0.40
CL110x124E	21	18.7	64.1	342	4.17	76.5	98	87	0.41
CL120x134E	21	18.7	59.0	373	4.98	83.5	98	88	0.45
CL125x139E	21	18.7	63.0	432	5.75	92	98	87	0.62
CL130x148E	28	25.3	93.8	547	7.85	123	98	86	0.85
CL140x158E	28	25.3	87.5	589	9.15	132	98	87	0.91
CL150x168E	28	25.3	82.0	631	10.6	141	98	87	0.97
CL160x178E	28	25.3	79.0	742	12.2	153	98	86	1.02
CL170x191E	33	30.0	83.0	830	16.3	192	98	86	1.50
CL180x201E	33	30.0	75.3	850	18.3	204	98	87	1.58

E CAPT-LOCKS Assembling diagram:

